

# MONTÁŽNÍ/MONTÁŽNY NÁVOD ELIGIA



**GB** Assembly instructions

**PL** Instrukcja montażu

**DE** Montageanleitung

**CZ** Montážní návod

**FR** Notice de montage

**SK** Návod na montáž

**NL** Handleiding voor de montage

**HR** Montaže

**IT** Istruzioni di montaggio

**TR** Montaj talimat

**HU** Szerelési útmutató

**RO** Instrucțiuni de montaj

**ES** Instrucciones de montaje

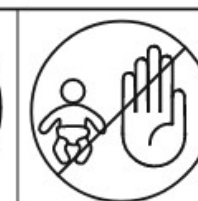
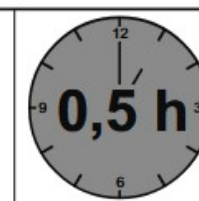
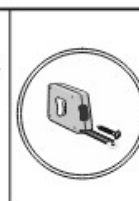
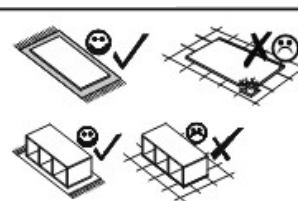
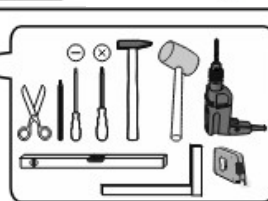
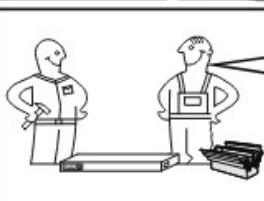
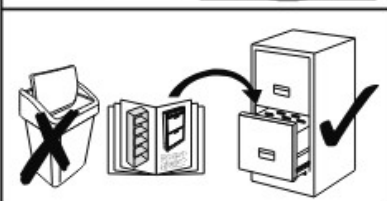
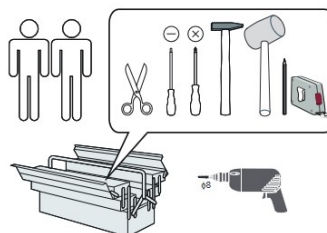
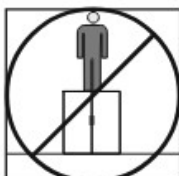
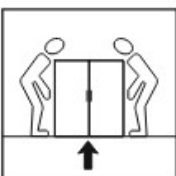
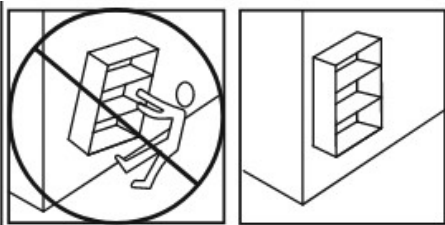

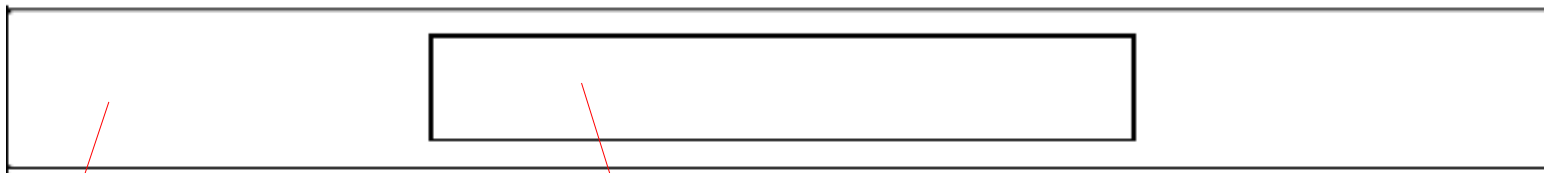

1

Dekor 2

3



3

1	1500	152	22
2	678	100	15
3	1500	188	8

Service • Assistenza • Dienstverlening • Serwis Servis • Szerviz • Servizio • Usluga •	
Name • Nom • Nome • Naam • Nazwa Jméno • Názov • Név • Denúmiere Nombre • Ime • Isim	COMO
Nr. • No. • N° • říčísł • Ć • Sz • Ne	47 07 MM 40
Typ • Type • Tip • Típus • Tipo	40

10 20 30 40 50 60 70 80 90 100 110 120 130 140 150 160 170 180 190 200



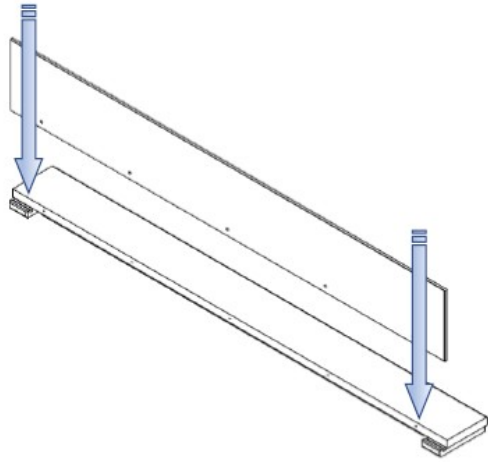

1.

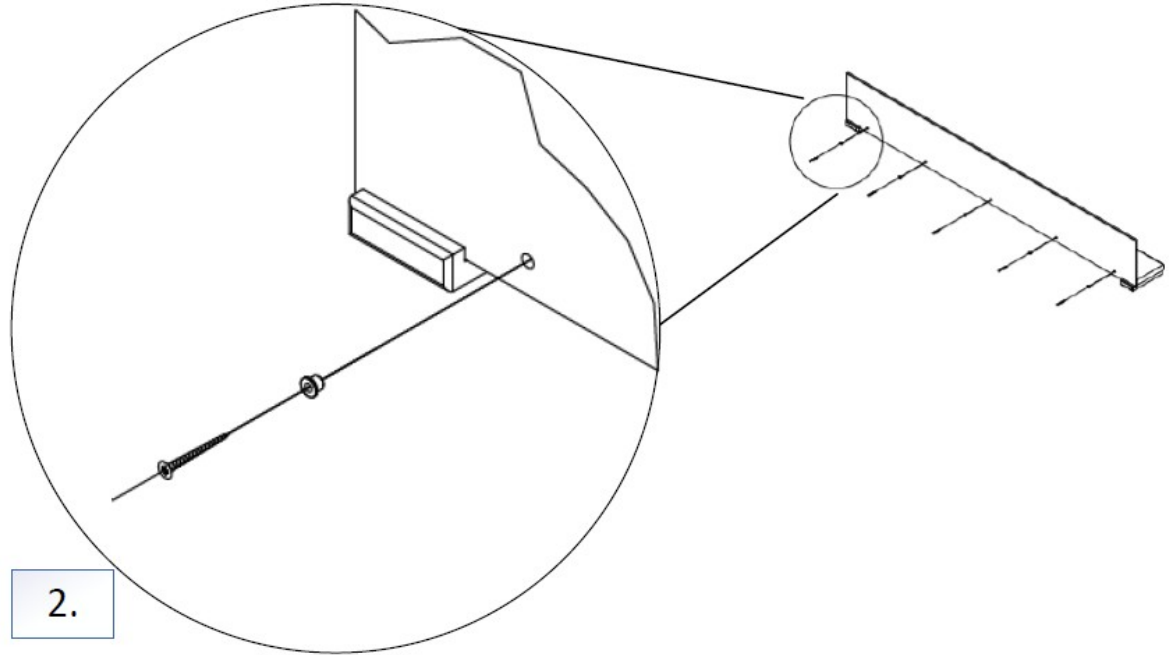

2.

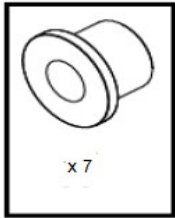

x7

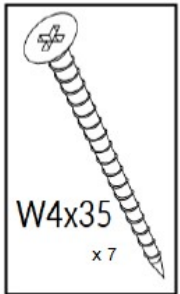

W4x35

x7

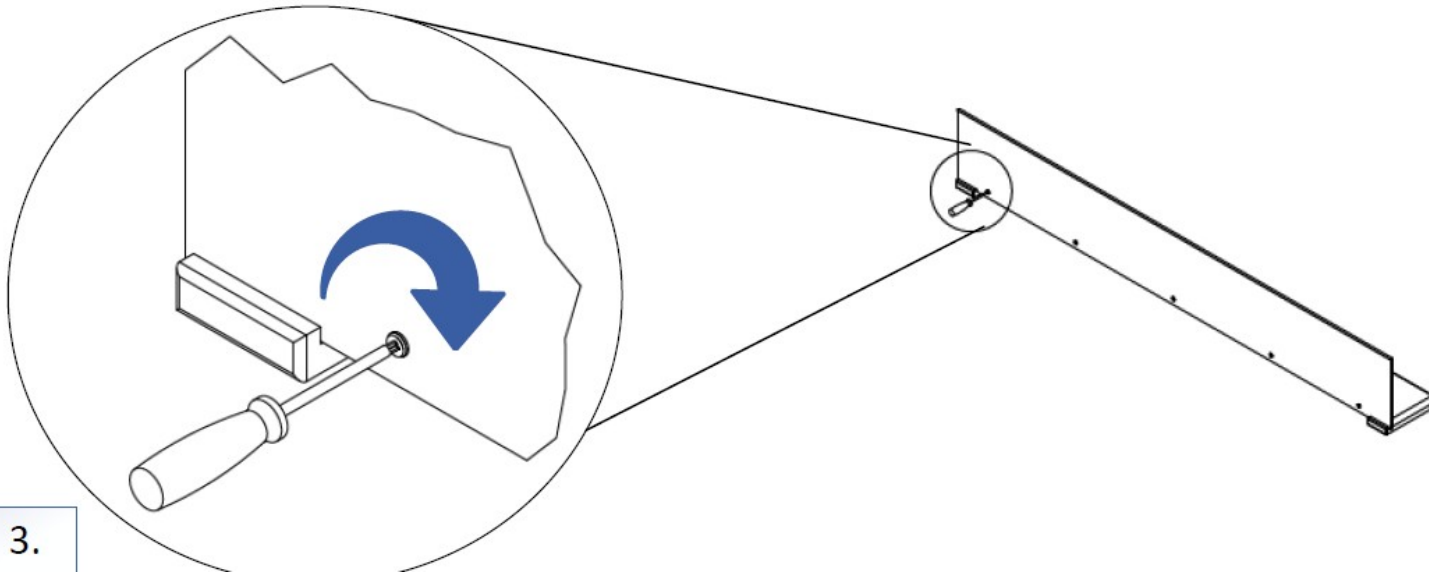

3.

